

Repair and Maintenance

- 1) Regularly wipe it with a piece of dry cloth.
- 2) Check the bolt and nut for connecting and tighten them if necessary.
- 3) Check whether the chain of the drive is unblocked; adjust it if necessary, and clean and lubricate it as well.
- 4) The rotatable parts of baby car should be often examined to see whether foreign matters hinder the rotation and keep a normal lubrication condition.

SCUDERIA FERRARI PEDAL GO-KART

Read Operation Instructions Carefully Before Use

LEAN CARS

WWW.LEANTOYS.PL



Ferrari

OFFICIAL LICENSED PRODUCT

Produced under license of Ferrari Spa. FERRARI, the PRANCING HORSE device, all associated logos and distinctive designs are property of Ferrari Spa. The body designs of the Ferrari cars are protected as Ferrari property under design, trademark and trade dress regulations.

MADE IN CHINA

K07-SMS-162-002

002-01

Dimensions of entire car

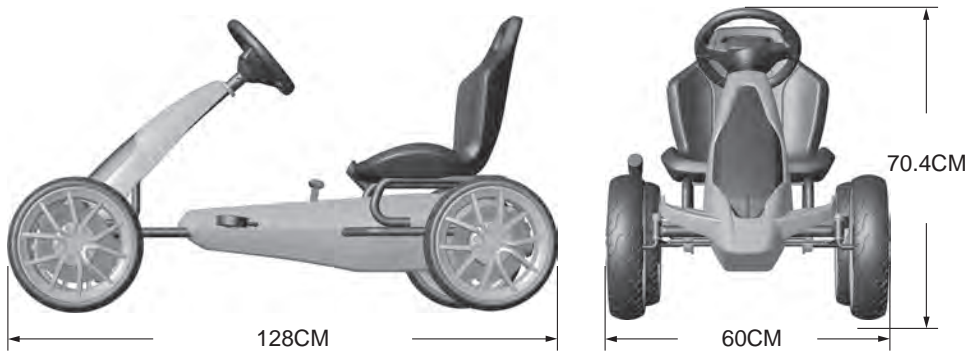

Contents

- I. Product Specifications and Parameters
- II. Components List
- III. Assembly Diagram
- IV. Function and Operation
- V. Simple Fault Removal Guidance
- VI. Warning

I. Product specifications and parameters

1. This product is suitable for the children of 5-10 years old, and should be used under adult supervision!
2. Product dimensions: 128x60x70.4CM
3. Product maximum load weight: 42 kg
4. Product operating ambient temperature: 0-40 C

II. Components List

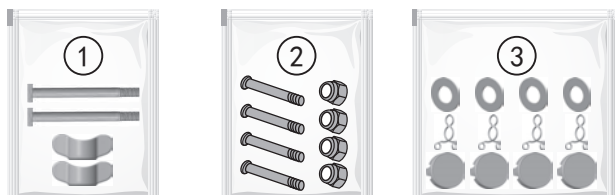
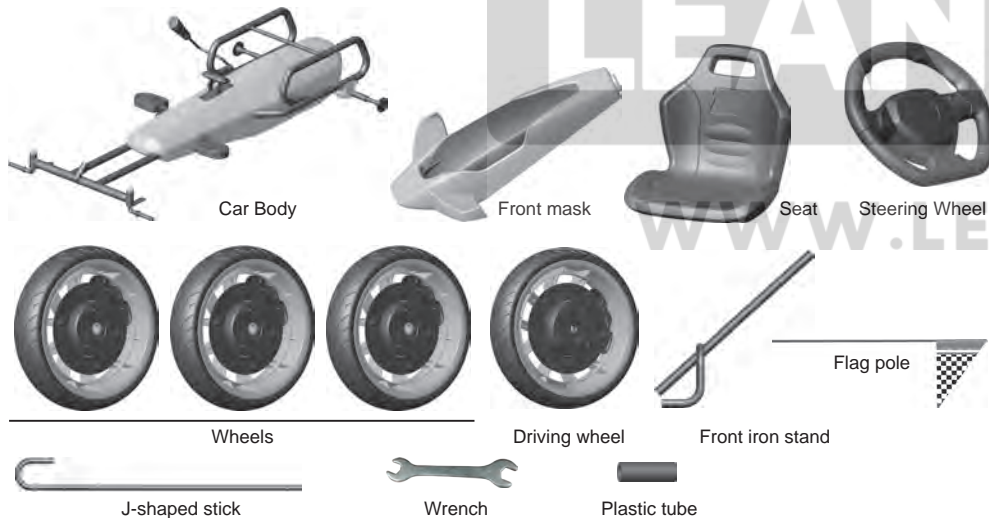

Seat screws (6x70PM)
Seat nut fixed component (6MM)

Screws for the front iron stand (5x47PM)
Locknuts for the front iron stand (5MM)

Washer (22.3x3)
Latch spring
Housing of wheel core

VI. WARNING

1. PRODUCT WARNING

- 1) Product assembly should only be undertaken by a responsible adult.
- 2) This product can be disassembled and the small parts may be swallowed by small children. Children using this product must be under the supervision of an adult at all times.
- 3) This product must be thoroughly checked for safety before allowing a child to use it.
- 4) It is recommended that children always wear shoes and other protective clothing and equipment (e.g. helmet, gloves, kneepads etc.) during use.
- 5) This product must only be used on a flat level surface. Do not use it on a public road or near dangerous areas such as steps, uneven ground, water etc.
- 6) The children shall correctly use the car under the adult guidance and supervision, otherwise they may make themselves or the others injured.
- 7) This car must only be used by a single child, maximum load 42kg.
- 8) Small parts possibly fall off when this product is used improperly. So, it is unsuitable for children under 3 years old.
- 9) Improper use may damage components.
- 10) The product packaging is not a toy and must be kept away from children. To avoid suffocation, remove all packaging material after product assembly.
- 11) These instructions contain important information, please retain them after product assembly.

2. WARNING



WARNING

To reduce the risk of injury, adult supervision is required at all times. In the interests of safety, DO NOT use this product on public roads, near motor vehicles, uneven ground, swimming pools or where there is water.

Product must only be used by one child at a time.



WARNING

Protective clothing and equipment should always be worn when using this product.



WARNING

Please keep the product and all parts away from children before full assembly has been completed by a responsible adult. Unassembled product contains small parts and potentially harmful sharp edges.

V. Simple Fault Removal Guidance

Problems	Check
Check whether screw caps and screws are tightened up.	Check the bolt and nut for connecting and tighten them if necessary.
Check whether the chain of the drive is unblocked.	Adjust the chain if necessary, and clean and lubricate it as well.

Adjustment of the chain gearing

The Ferrari go-kart has a chain and sprocket drive. The chain should be added enough lubricating oil to ensure the normal driving. If the chain is too tight, the go-kart will be difficult to be driven and the sprockets may be worn or broken much likely than other parts. If the chain is too loose, it may be disengaged from the sprocket, thus damaging the outer cover of chain. See below for the adjustment of chain tightness:

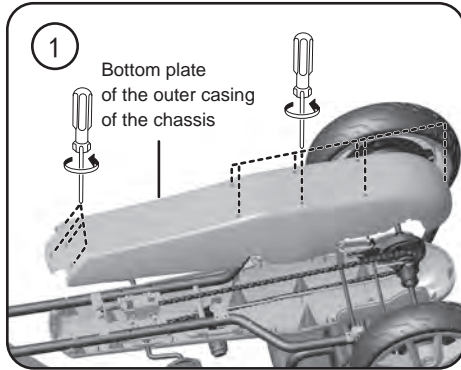

Turn the car upside down, remove the screws and open the bottom plate of the outer casing of the chassis.

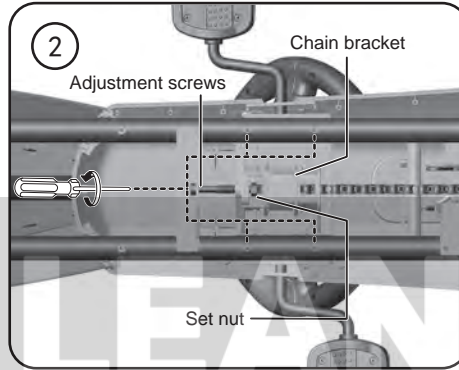

Loosen the four screws on the chain bracket and loosen the set nut with the small wrench. Turn the adjustment screw with screwdriver to adjust the chain tightness. Turn the screw clockwise to tighten the chain.

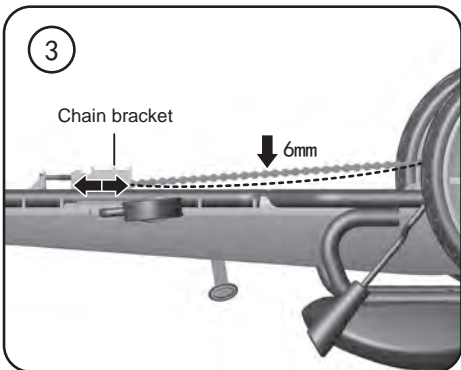

Move the chain bracket to the left or right to adjust the chain tightness. The most suitable stroke of chain tension is 6mm.

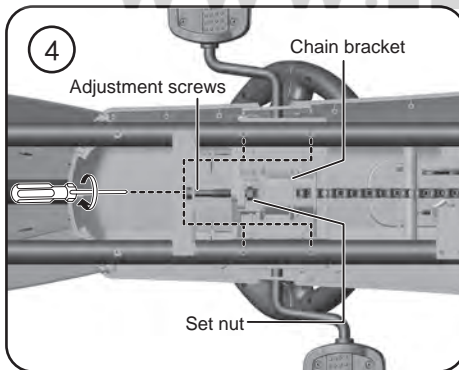

After the chain adjustment, tighten the set nut and adjustment screws with the small wrench, tighten the four screws on the chain bracket. Close the bottom plate of the outer casing on the chassis, and then tighten the screws.

III. Assembly Diagram

1. Mount the front iron stand

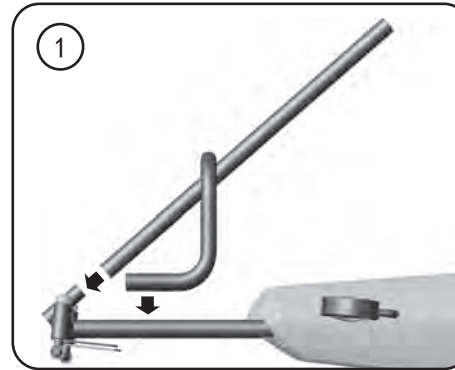

Align and mount the front iron rack on the car body.

2. Mount the J-shape iron hook

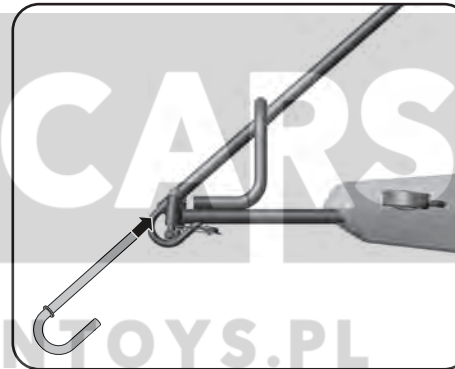

Hitch the J-shape iron hook on the iron tube from the bottom.

4. Installation of steering wheel

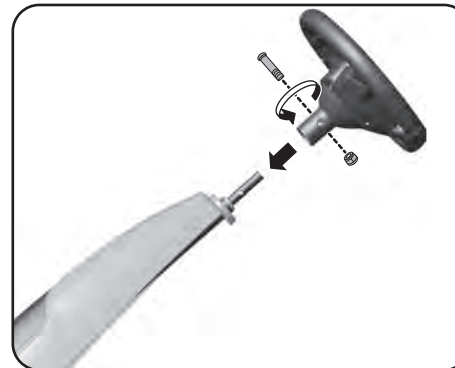

Remove the screw, mount the steering wheel to the J-shape iron hook, and then tighten the bolts and nuts.

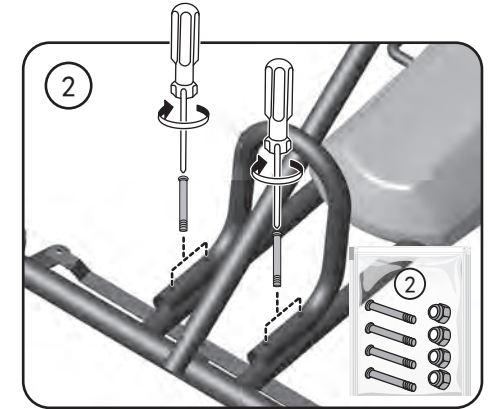

Tighten with the screws and locknut in No.2 screw kit.

3. Mount the front mask.

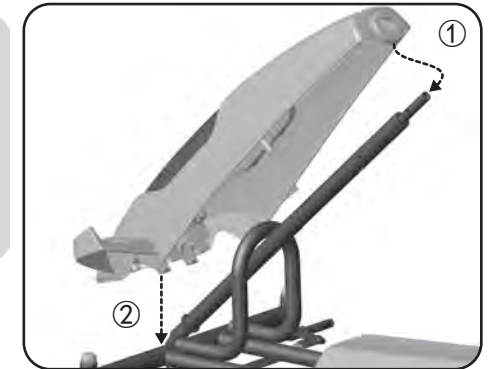

① Insert the iron tube into the hole on the top of the head part.

② Align with the iron tube and fasten up.

5. Mount the seat



Mount the seat on the car body.

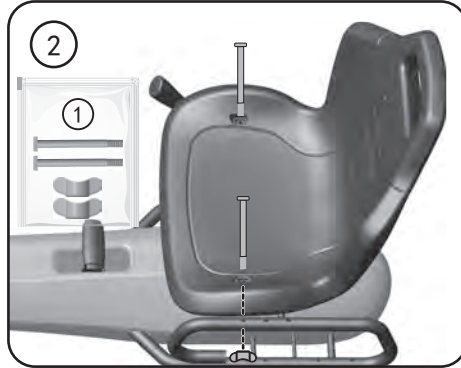

Tighten the screws and nuts fixed component for the seat in No.1 screw kit.

6. Installation of Front Wheel

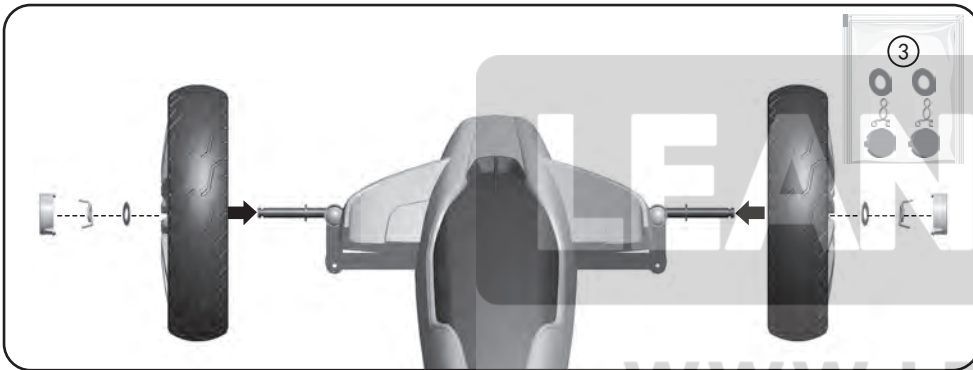

Mount the front wheel, meson and retaining spring in sequence, and finally put the cap on the wheel boss.

7. Installation of rear wheel

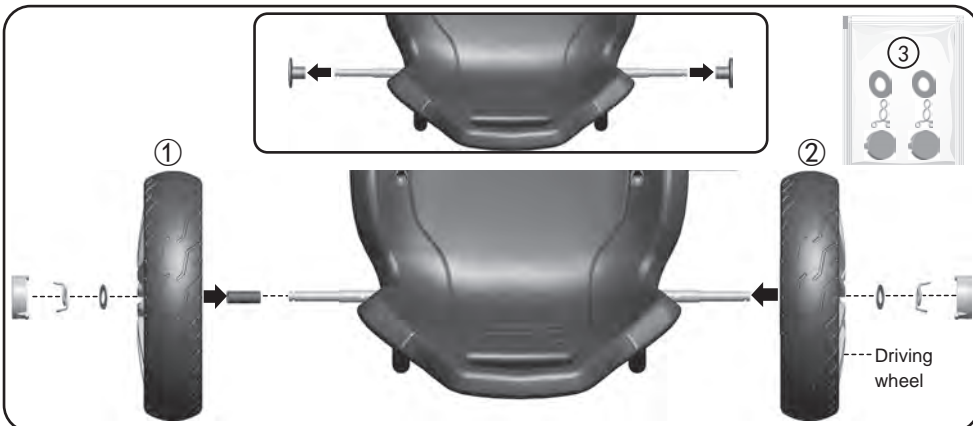

Remove the plugs on both ends of iron tubes of the rear wheel shaft. ①Mount the rubber sleeve, rear wheel, meson and retaining spring in sequence, and finally put the cap on the wheel boss. ②Mount the driving wheel, meson and retaining spring in sequence, and finally put the cap on the wheel boss.

8. Install flag pole



Insert the flag into the hole at the rear of the toy car.

9. Assembly completion drawing



IV. Function and Operation

- 1) The kid sits in the car, grips the steering wheel, toggles forward the clutch, and steps on the pedal. Step forward to drive the car forward and step backward to drive the car backward. Pull back the brake rod to stop the car.
- 2) The steering wheel is used for turning.
- 3) Have automatic parallel landing function of 4 wheels.

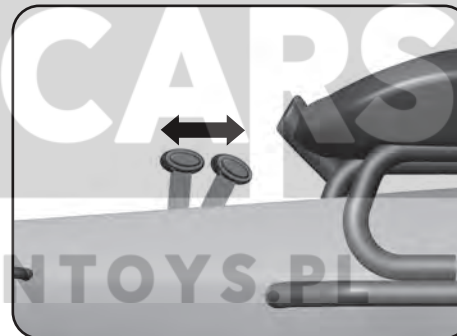

When the clutch is toggled forward, the car can be driven forward and backward with pedal. When the clutch is toggled backward, the car can only be moved by hands.

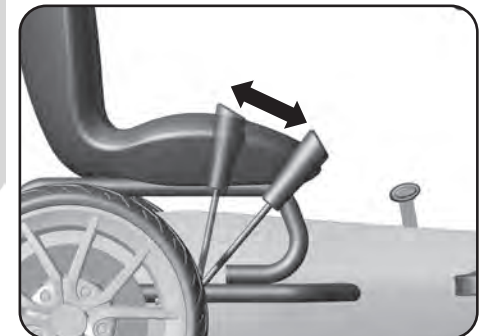

Pull back the brake rod to stop the car.

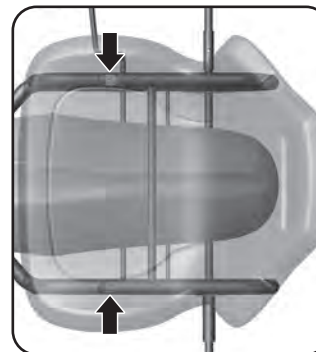

Seat level 1

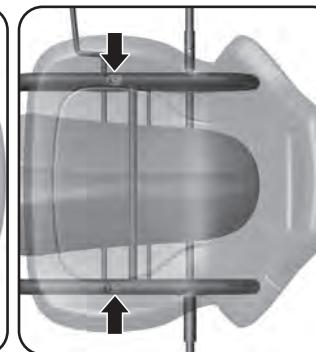

Seat level 2

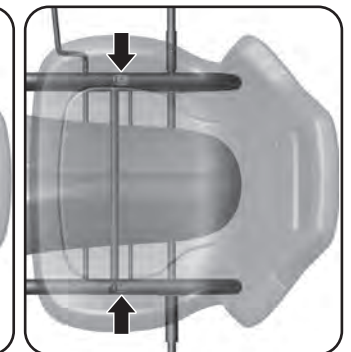

Seat level 3

Seat adjustment: Remove the screws and mount the seat by aligning the screw hole of another level.