

MALFUNCTION ELIMINATES:

Vehicle couldn't move	1,Check whether the power switch is off.
	2,Check whether the forward/backward switch is in the neutral gear (in the middle)
	3,Check the fuse is damaged,if so ,change it.
	4,Check whether the battery wires are connected well?
	5,Charger's dc in the charging socket will make it not work,if so ,take it out.
	6,Check whether stepped on the pedal.
	7,Check whether anything trapped in the wheels.
Vehicle move slowly	1,Check whether the battery be fully charged.
	2,Check whether anything trapped in the wheels.
	3,Check whether the vehicle is over loaded.
Vehicle cannot be charged	1,Check whether the charger or battery is damaged.
	2,Check whether the charger and the battery is well connected.
	3,The charger or battery if there is a loose connection.

WARNING

- 1,This note is to use illustrations to illustrate the operation of the product and product structure, there are a few differences, in kind prevail.
- 2,In order to improve the quality of the products, under the condition of without telling, we may make changes to the product part of the structure with the appearance, please understanding

CHILDREN'S ELECTRIC CAR INSTRUCTION

Please read this instruction carefully before use.

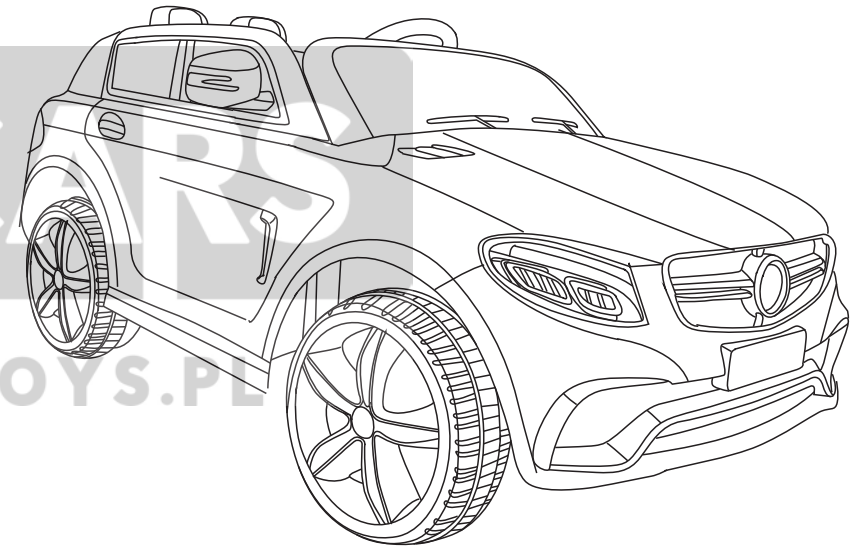

- Suitable age 37-96months.
- This product should be assembled by adult.
- This instruction contains important safety information content,please keep it as a reference.
- Executive standard: GB6675-2003.GB19865-2005.

About the products





Thank you for choosing our children electric car. We always keep pursuing being outstanding and designing comfortable and safe ride on car for children, and give your children a wonderful childhood.

Please read this instruction carefully before use, it will tell you the right way of assembling and operating. To avoid incorrect operations damaging the product or injuring your baby, please keep this instruction.

Specifications

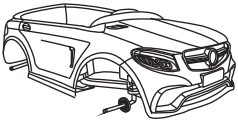
Battery:		12V7Ax1/6V7Ax2	
Main material:		PP	
Suitable age:	37-96months	Maximum weight:	30kg
G.W:	23kg	N.W:	19kg
Car Size:	121x 75x57.5cm	Package Size:	121x 61x39cm
Speed:	3-5km/h		
Operation time:	1-2hours after charging about 8-12hours		
Charge:	Input AC220V; Output DC12V1000mA		
Fuse:	Resettable Fuse		

Part List

Part Number	Part Name	Picture	Q'ty (pcs)	Part Number	Part Name	Picture	Q'ty (pcs)
1	Main body		1	2	Seat		1
3	Wind shield		1	4	Steering wheel		1

MAINTENANCE

1. Check the main parts regularly, check if there's any damage of the battery, charger, plug, cover and the other parts, check if the screws are tight, check if the wire lead is old. If any damage, please stop use and deliver to the professional service.
2. Clean the iron parts with little lubricating oil after a time of use to avoid rust.
3. Keep the car away from fire, avoid direct sunshine; always turn it up but not turn it over; put in dry place when not use, and do not dump the car, Keep the car inside door room or cover it with cloth when wet weather.
4. Keep the car away from hot objects like stove or heater, for the plastic might be melted; when charging, keep it away from flammable materials to avoid fire.
5. Charge in time after use, and do it by adult, When the car will be not used for long time, ensure it be charger and charge once every 3 month to keep the battery life.
6. Clean the vehicle by dry soft cloth, do not use any chemical solvents, soap or water, Do not drive in raining or snowing days.
7. When stop using the car, cut off the power, turn all the buttons to "stop" or "off".
8. Do not use inconsistent fuse.
9. Do not change the line system, structure and additional electric system of the vehicle by yourself, repair work must be done by career man or under professional supervision.
10. Toy is not to be used for other purposes
11. In the correct polarity in the battery
12. It is forbidden to battery is negative short circuit
13. The rechargeable battery can't charge
14. Rechargeable batteries can only be charged under adult supervision
15. The old and new batteries and different types of batteries cannot be mixed use.
16. Run out of batteries extracted from toys to properly handle, prevent children playing.
17. When stop using the car, cut off the power, turn all the buttons to "stop" or "off", properly handle, prevent children playing.

WARNING: NOT TRAFFIC TOOL, TO KEEP SAFE, ADULT'S SUPERVISION IS REQUIRED.

To avoid the fuse trip cause cut the power ,please note the things as follows:

The max loading is 30kgs,do not over the loading.

Do not drag everything .

Do not let the water or other liquid touched the circuit,battery and other parts.

Never modify the structure and the electric circuit system.

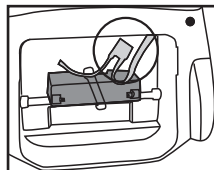

CHARGE

- This product charge should by adult for safety.
- Before operating for the first time, please open the hood and connect the power wires with the wires of storage battery, red to red, black to black. Please charge the battery for 8-12 hours.
- The charging jack is on the fuel tank cap,the steps as follows:
- When drive slow,should charge 8-12hours in time,can't be over 20hours.

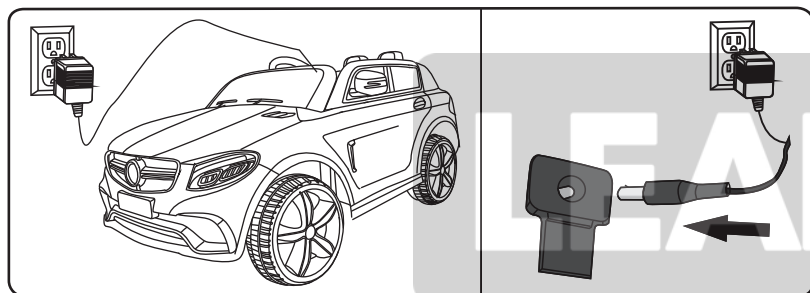

- 1.Insert the charger tap charging hole
- 2.Insert the charger to the power socket (The car won't start for charging status)

NOTE:

- Only Only can use the manufacturers specified battery and charger.
- The old and new batteries and different types of batteries cannot be mixed use.
- Do not open the battery and charger.
- Do not overturn the battery.
- Before charge,please confirm whether the charger battery and the jack are well,if damaged,stop use,until restored.
- When charging,the battery will be warm,it's regular or the battery maybe damaged.
- Must use the platen fasten the battery,the battery will hurt the children when the car overturn.
- The adult should bring out the battery,proper recycling.
- When the car will be not used for long time,ensure it be charged and charge once every 3 month to keep the battery life.
- The charger is not toy,keep it away from the children.

Part Number	Part Name	Picture	Q'ty (pcs)	Part Number	Part Name	Picture	Q'ty (pcs)
5	Gear box		2	6	Rear-view mirror		1
7	Driving wheel		2	8	Side window		1
9	Wheel		2	10	Remote Control		1
11	Wheel Cove		4	12	Rear wing		1
13	Charge		1	14	Rear axle		1
15	Steering iron parts		1	16	Tool bag		1
17	Instruction		1	18			

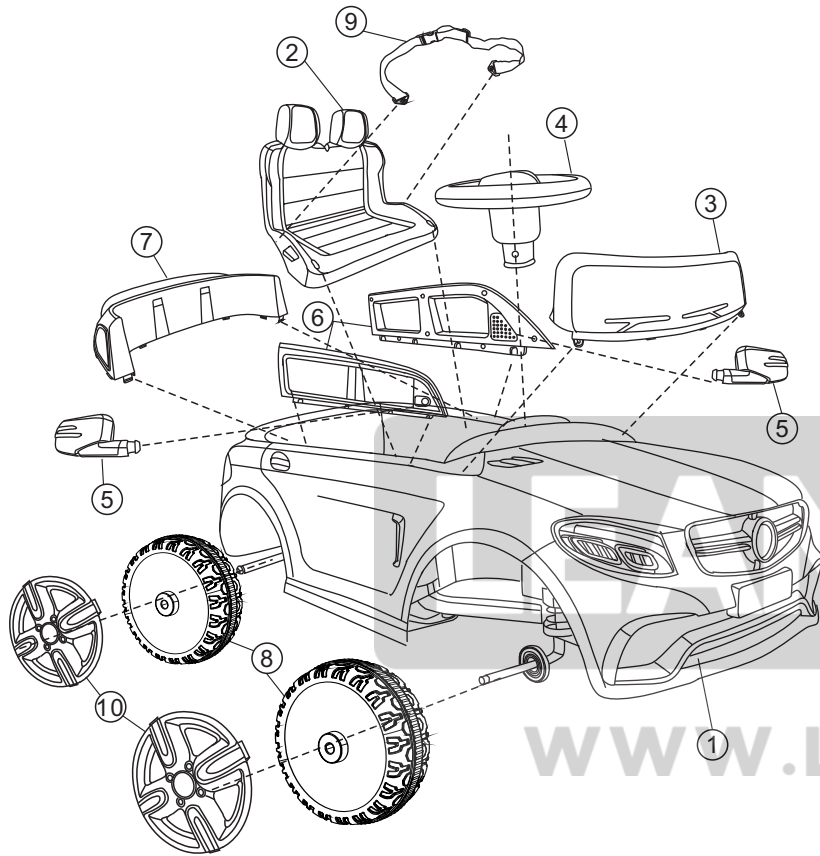

①	Main body x 1	⑧	Driving wheel x 4
②	Seat x 1	⑨	Safety belt x 1
③	Wind shield x 1	⑩	Wheel Cove x 4
④	Steering wheel x 1	⑪	
⑤	Rear-view mirror x 1	⑫	
⑥	Side window x 2		
⑦	Rear wing x 1		

2.4G Remote Control Instructions

For the first time need to code, this product has a memory function, replacement battery next time, you do not need to match the code once again.

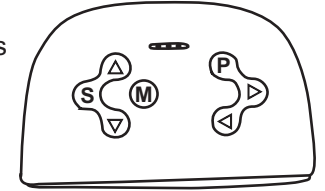

- ①. Press the "S" key to boot, and then press the "M" button for 2 seconds until the LED flashes quickly.
- ②. Open body power, LED turns a long bright on the success of the code.
- ③. Remote control 2 minute without operation of automatic shutdown, press the "S" key to boot.
- ④. Key Description: Δ Forward ∇ Backward \triangleleft Left \triangleright Right
S: On/Off **P**: Stop
 Press the "P" key to keep the brakes, Indicator light flashes slowly, press the brake button again to lift the brake. Press the "S" key button for 2 seconds until shutdown.

WARNING

- 1, When using the remote control, please keep less than 10m to the car.
- 2, The remote control should be operated only by adult, keep it away from the children.
- 3, Before use, please read the instruction carefully, and make the empty test, do not allow childrendrive before you know how to control.
- 4, Do not use this product on road, water or other place with barrier.
- 5, To avoid the circuit damage, please do not use the remote control in rain or other way might causesoaking.
- 6, Do not mix new and old batteries or different batteries.
- 7, When not use for a long time, please remove the battery in case it cause any damage to the citcuit board and the remote control.
- 8, Do not drop the remote control when using.
- 9, Take care of the remote control, do not lose it.
- 10, If the remote control can work no far than 3m, it might because there's not enough battery, please replace the cell inside the remote control.

Change the batteries: Remove the battery cover, put 2 batteries in side the remote control, then fasten the cover.

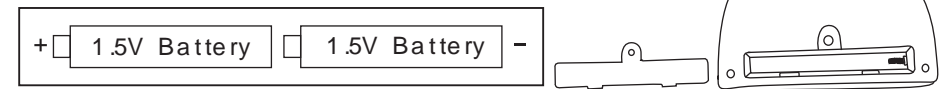

FUSE

This product configure self-resetting fuse, when the driving car stopped, mainly because of the current exceeds the specified value, at this time, you should wait 8 seconds, then the fuse will automatic reset.

HOW TO OPERATE YOUR VEHICLE

1. Before use, must be confirm the product as follows:

- According to the instruction assemble the car, connected well.
- Make all the screws fastened tightly in the right place.
- Before driving, parents should tell your children safety rules and make them understood.

In order to reduce dangerous:

- Please sit on the seat when driving.
- Only one child drive every time.
- Driving must be under the adult supervision.
- Note the driving in safe place, keep driving on hard and flat ground, DO not drive in dangerous places.
 - a. ditch pit, river side, slopes or other uneven ground.
 - b. Beside the road or other places for cars and people walking.
 - c. Barrier which might cause damage and injury.
 - d. Other dangerous places.
- Do not drive in black, it may cause injury. Do drive in day time or bright places.

2. OPERATE AS FOLLOWS

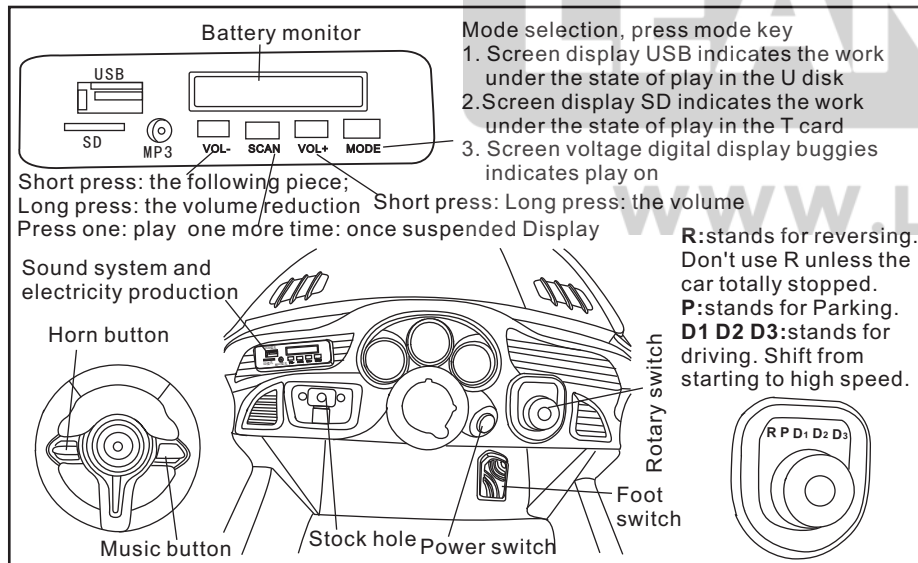

Note: Must tell your children, When change gears, release the foot switch, after the car stopped. Do not change gears when the car is driving, or damage the line and other parts.

Assembling

- The vehicle should be assembled by adult before use.
- The small parts might cause choke, please keep away from the children. Children under 36 months can not use.
- Please check the number of the parts before assembling, and keep the packaging bags away from the children in case of choke.

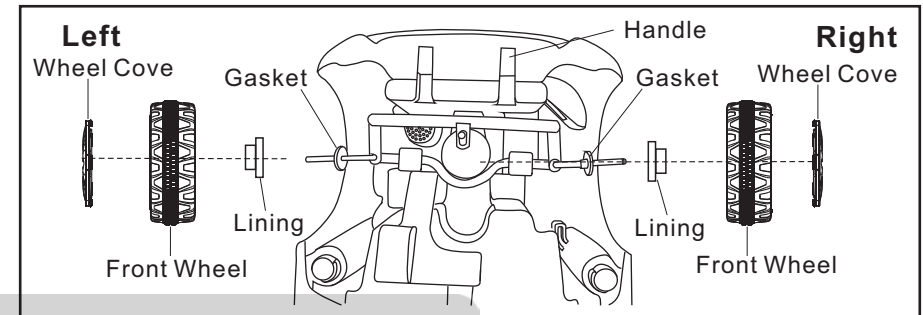

1. Assemble the front wheel

Turn over the car body, put the front wheel with gasket on left and right axle, press the button at the center of wheel when install. To make sure the wheel was fasten well. (two sides are same)

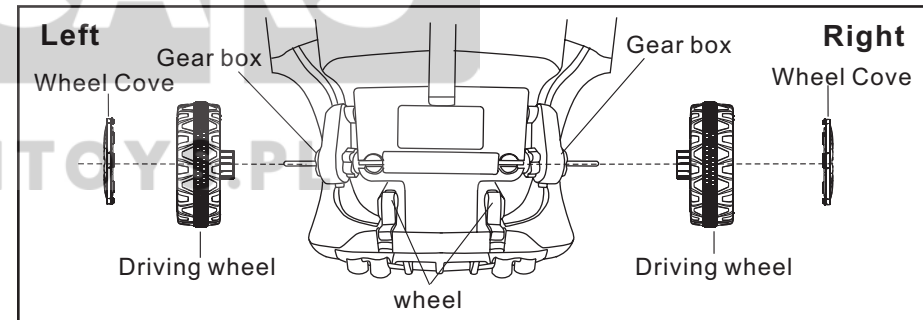

2. Assemble the rear axle

The rear axle go through the motor first, block the metal plate into the gear, fix from body side to body axle hole as the picture showed.

3. Assemble the rear wheel

Let the rear wheel go through the left and right side of the rear axle, press the button at the center of wheel when install. To make sure the wheel was fasten well. (two sides are same)

Put down the wheels at the rear of the car, pull out the handle at the front of the car then take the car.

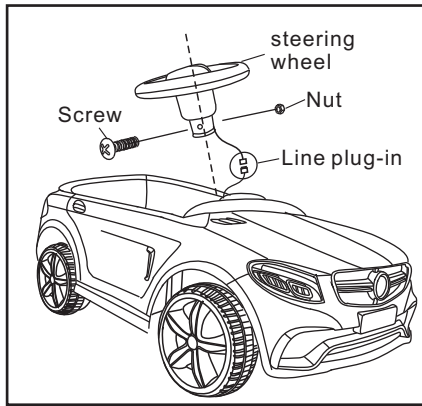

4. Assemble the steering wheel
Insert cable plug-in well first, then hold the steering wheel in the steering rod, fixed it by screws and nuts.

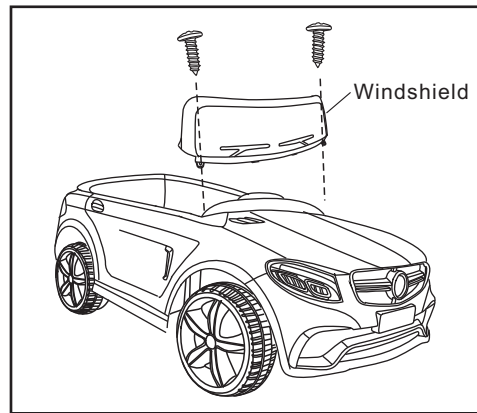

5. Assemble the wind shielder
Aim the wind deflector neck car body down on inserts, fix with two self-tapping screws on both sides

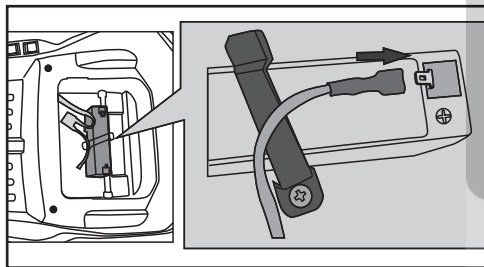

6. Connect the power
As showed in the picture, connect the motor plug-in with the car, then connect the power plug-in with the right direction.

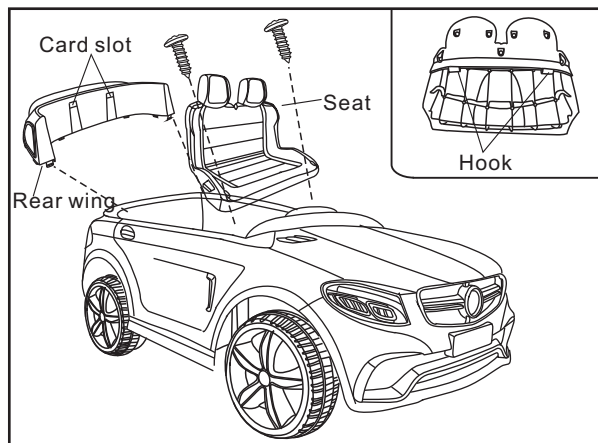

7. Assemble the empennage and seat cushion buckle into the body corresponding to the position, fix the snap with the neck on the car body, then fasten by reoccupy two self-tapping screws

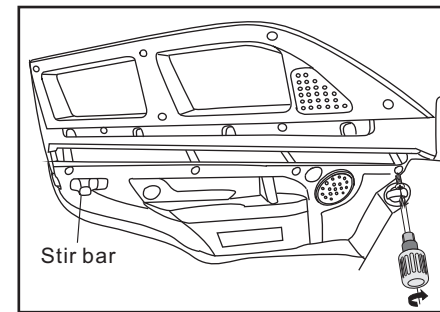

8. Assemble the lateral of the car window
The side window get stuck at the door of the corresponding hole and fixed by the screw. The door can open after push the shifter lever

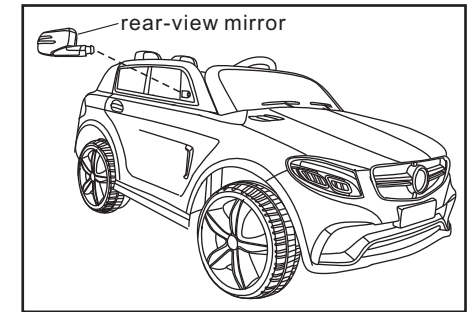

9. Assemble the mirror
Insert the mirrors into the hole on the car body tightly.

GIVE SAFETY EDUCATION BEFORE USE

1. To avoide harmed by the little spare partsI ,less than 3years old can't drive.
2. Assembled and charged Only by adult,
3. The max loading is 30kgs, suitabal for 3-8years old children. Do not over loading for safety.
4. This product is not traffic tool, keep driving on hard and flat ground.
5. Do not drive in the dangerous place, like street, road or sloap.
6. Do not drive the mire or uneven places.
7. Children should be instructed to the correct operation, to prevent the damage caused by improper operation, accident
8. When change gears, release the foot switch, after the car stopped.
9. When driving, adult care and supervision is necessary, Do not leave and keep your childin your sight.
10. Do not let the product in rain or other ways touch water, avoide damage the circuit and motor.
11. Check whether the charger, plug-ins, and other parts are in good condition and well connected in time.
12. To make sure safety and use longer, avode damage the charger, battery or system, must be use the originals.
13. When stop using the car, cut off the power, turn all buttons to "stop" or "off" .
14. The charger and battery of the products are not toy, forbidden.
15. Do not use the spare parts not supply rom us.
16. The product mainly use PP, safety use tiome is 2years.