

Mercedes-Benz UNIMOG

USER MANUAL

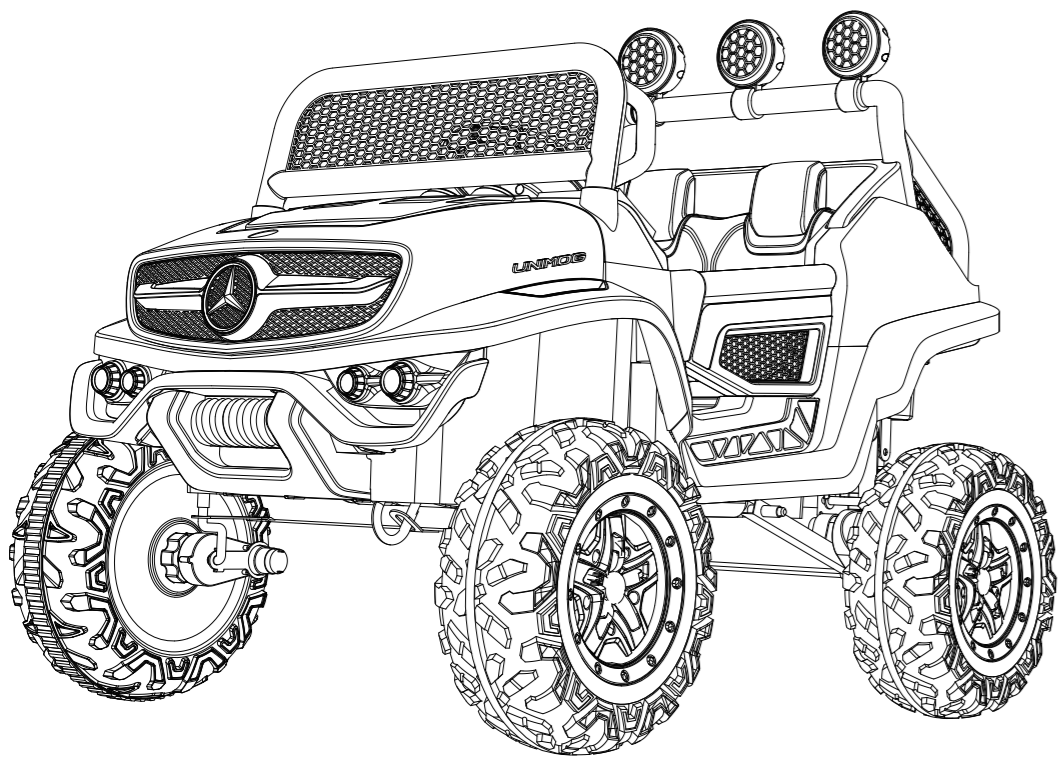

- For age: 37-96 months
- Maximum weight capacity: 30 kg
- This product contains small parts that are for adult assembly only.
- Ensure charge the battery for 4 hours before first use.



The vehicle must be assembled by an adult who has read and understood the instructions in this manual. Keep instructions for future reference.

OFFICIAL LICENSED PRODUCT

LICENSE

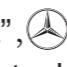
"Mercedes-Benz", , and the design of the enclosed product are subject to intellectual property protection owned by Daimler AG. They are used by Pinghu city Julong Children's Commodity Factory under license.

COMPANY PROFILE

Pinghu city Julong Children's Commodity Factory is a children's Goods Factory integrating R&D, engineering, production, quality control and sales. The main products are children's electric cars, children's bicycles and other products. The company has several professional production lines, with annual production capacity reaching hundreds of thousands of vehicles. The company has a professional R&D engineering team, which has been working for many years, with complete testing equipment, to ensure that the quality of products produced by the company fully meets the requirements of national standards.

SPECIFICATIONS

Battery Model : 12V7Ah (or 12V10Ah or 12V14Ah)
 Weight Limit : 30kg
 Running Speed : 3-5km/h
 Charger Output : DC 12V1000mA
 Age Grading : 37-96 months
 Vehicle Size : 1080x800x880mm
 Normal Charging Time : 8-12 hours
 Fuse : WHPTC
 Motor : Steering motor :12V 380#6600
 Drive motor :12V 390#16000

1

MAINTENANCE

- After the regular service of the product, adults should regularly (suggest once two weeks) check the main items, including storage battery, charging device, wires, outer skin, circuit changer and switching valve. Clamp devices should be checked to see whether is loose. When there's hidden danger, the product should be stopped being used until restored.
- The vehicle should be cleaned by slightly wet (no water drop) soft cotton. Also can be polished by non-wax furniture in order to make the surface bright and clean. Do not use chemical dissolvent to wipe the plastic part of the toy to avoid being dissolved. The car cannot be cleaned by soap and water since water will damage the motor and storage battery, causing short pass of the electro-circuit system.
- After using for a period of time, please use lubricating oil to lubricate the iron part in order not to get rusty. The car should be kept away from high temperature and moistness, since the plastic parts might melt. When charging, please keep it away from inflammable materials so that fire will not occur.
- When stop or not using for a long time, please cut off the power. All the circuit changers should be switched to "STOP" or "OFF". The structure and wire system cannot be altered without authorization. Maintenance and replacement of crucial parts should be supervised by professionals.
- In areas where power supply is unstable, installing power regulator is highly recommended to protect the storage battery when recharging do not use safety wires not accord with the product.

2

PARTS LIST

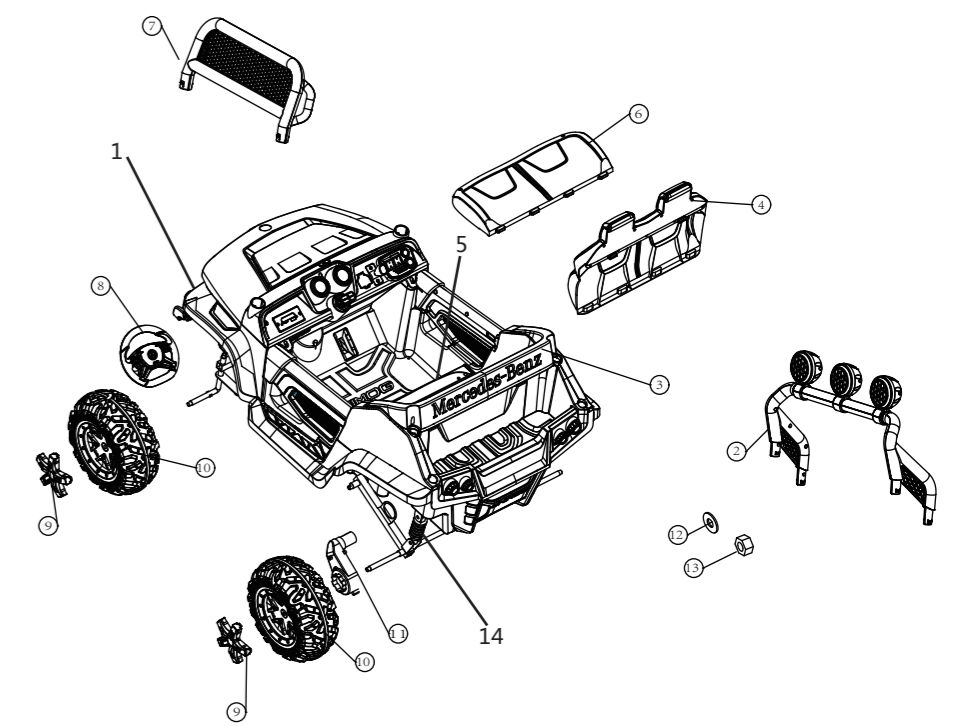

NO	NAME	NO	NAME	NO	NAME
1	Body	6	Seat	11	Gear box x2(or x4)
2	Rear tailstock	7	Windshield	12	Shim
3	Fence	8	Steering wheel	13	M10 nut x4
4	Seat back	9	Wheels coevr x4	14	Shock absorbers
5	Underseat fastener	10	Wheel x4	15	

3

ASSEMBLY INSTRUCTIONS

Ensure all parts indicated in the parts list have been indicated in the box. We recommend you keep the original packing materials until the unit is fully assembled, to ensure that no parts are discarded.

Assembly of your new vehicle should take approximately 30 minutes. Adult assembly is required.

WARNING: Children can be harmed by small parts, sharp edges and sharp points in the vehicle's unassembled state, or by electrical items.

WARNING: CHOKING HAZARD - small parts Not for children.

Tools Required

Phillips Screwdriver (Not included), Pliers (Not included)

Internal Hexagonal Wrench (Included), Socket Wrench (Included)

Optional: Gear box *2 or Gear box *4

Installing the front shock absorbers and front axle

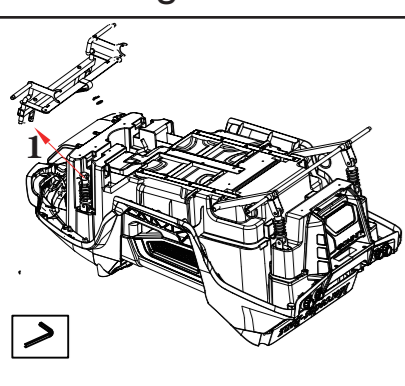

- Put the body lie on the flat surface before installing.
- Take down the bolt and nut in the bottom of absorbers. Put the absorbers' bottom into the "U" trench on the axle. Put the bolt back to absorbers, locking the nut with internal hexagonal wrench.
- Repeat on other side.
- Axle's square tube needs match the Body's trench, meanwhile axle's hole match the steering axle. Screwed up the top of shock absorbers onto the body with 4*12 self-tapping screws.
- Slide the 10MM shim onto steering axle. Then slide the spring onto the steering axle's trench.

Installing the front gearbox and front wheel

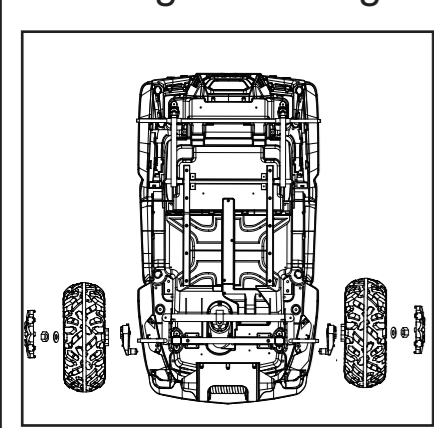

- Slide the gear box onto the front axle. Insert the gear box motor cable wiring into interface leading to the battery compartment. (Noted: Gear box divided into FL/FR. (This step suitable for gear box *4)
- Slide the wheel, 10MM shim, nut onto the front axle. screw up the nut with socket wrench. (Noted: Wheel's bulge needs match the gear box)
- Attach the wheel cover onto the wheel, pushing firmly until it clicks into place.
- Repeat on other side.

4

ASSEMBLY INSTRUCTIONS

Installing rear shock absorbers

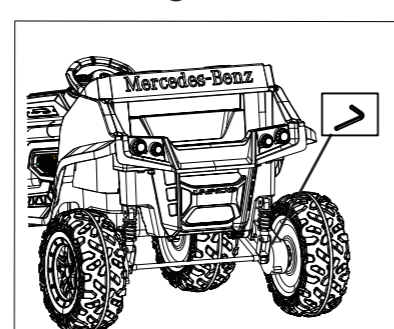

- Take down the bolt and nut in the bottom of absorbers. Put the absorbers' bottom into the "U" trench on the axle.
- Put the bolt back to the absorbers, and lock the nut with internal hexagonal wrench.
- Repeat on other side.

Installing the rear wheels

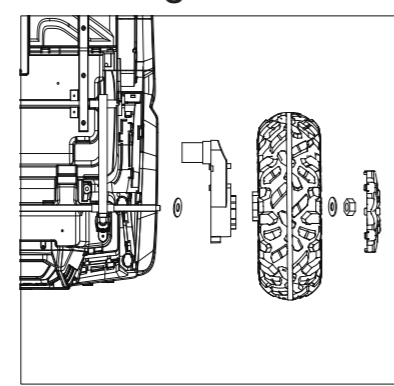

- Slide the rear axle onto the after-support's hole.
- Slide the 12MM shim, gear box, wheel, 10MM shim, nut onto the rear axle. (Noted: Gear box divided into L/R. Wheel's bulge needs match the gear box)
- Repeat on other side.
- Screw up the nuts on both ends of axle with socket wrench.
- Attach the wheel cover onto the wheel, pushing firmly until it clicks into place.
- Repeat on other side.

5

ASSEMBLY INSTRUCTIONS

Installing fence

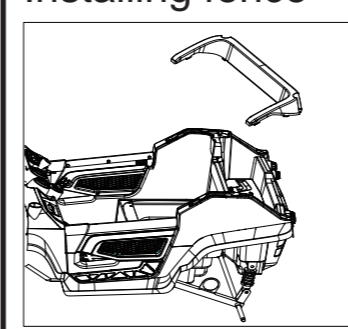

- Attach fence onto car body's trench, pushing firmly until it clicks into place.
- Screw up both side of fence on the car body with 4*12 MM self-tapping screws.

Installing the seat

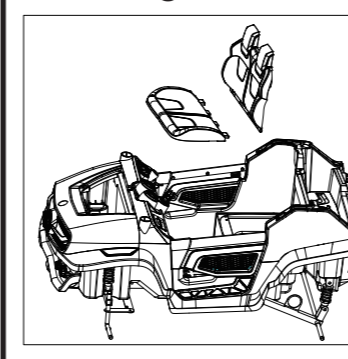

- Noted: Connect the interface of rear gear box wires before installing the seat. Interface do NOT divided into L/R.
- Screw up safety belt onto the middle of the underseat fastener with 4*12 MM self-tapping screws.
- Attach seat back onto car body's trench, pushing firmly until it clicks into place.
- Slide seat into seat back's trench. Screw up seat on the underseat fastener with 4*12 MM self-tapping screws.

6

Installing Searchlight and rear tail stock

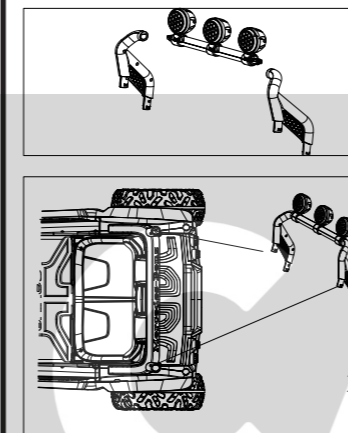

- Connect searchlight's interface to the jack in the rear tail stock.
- Attach rear tail stocks into searchlight's support, pushing firmly until it clicks into place. (Figure 1)
- Attach the whole rear tail stock onto the body's trench, pushing firmly until it clicks into place. (Figure 2) (Noted: Be careful the light wire.)
- Connect the light wire's interface to the jack under the car body.

7

ASSEMBLY INSTRUCTIONS

Installing steering wheel

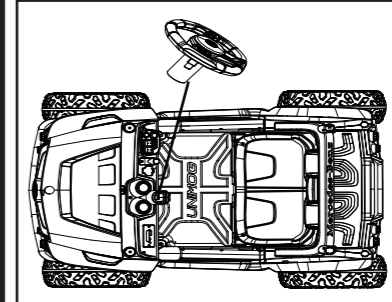

- Connect the steering wheel interface to the jack on the steering rod's fixed base.
- Push connected jack and interface into the base.
- Attach steering wheel into steering rod's fixed base, pushing steering wheel down until it clicks into place.

Installing the windshield

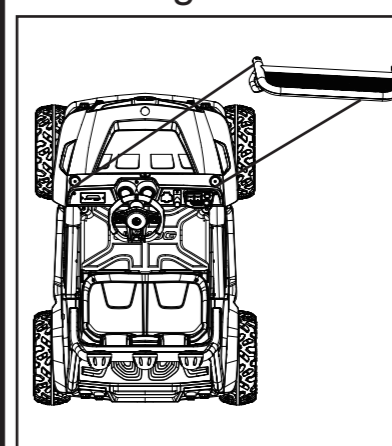

- Fix the windshield into the windshield slots on the car body. Gently push down until it clicks and secures into place.

Connecting the power

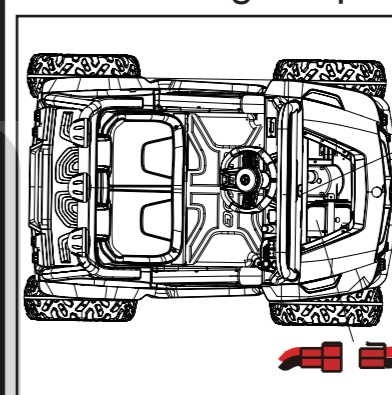

- Open the hood, connecting the battery interface to the jack. (Figure 1)
- Close the hood, screw up the hood on the car body with 4*12 MM self-tapping screws. (Figure 2)

7

MANUAL FUNCTION

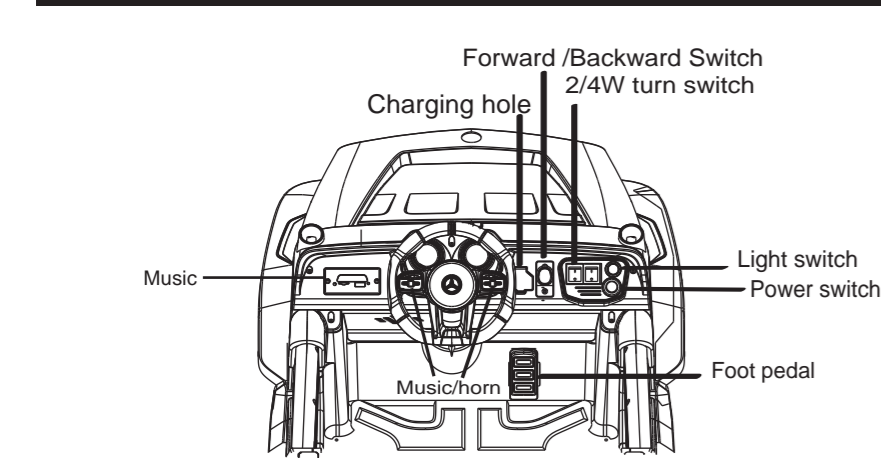

WARNING!

Ensure the vehicle totally stop before changing the forward/backward switch to avoiding gear box's damage.

Operation Instructions

Power: Push the power switch to turn on the car.

Press the power switch again to turn off the car.

Pedal: Press the foot pedal down to go. Release the foot pedal to stop.

Forward/Backward: Push switch up to D to move forward. Push switch back to R to move backwards. Push switch to P to park.

Right/Left: Use the steering wheel to turn in directions left or right.

Light Switch: Press the light switch to turn on and off light.

Horn: Push the button on the right for horn sound.

Music: Push the button on the left to switch between music channels.

2/4W Switch: Press the switch to change two-wheel drive or all-wheel drive. (This button is only available in all-wheel-drive.)

8

MANUAL FUNCTION

Using 2.4G Remote Control

Installing or changing batteries: Push down battery cover located on the of the remote controller to open

Install two AAA batteries matching polarity (+, -) correctly then close cover. First Use: Pairing Vehicle with Remote control

Hold down Forward Key and Backward Key for 3 seconds.

Speed indicator light flashes. Turn on car power switch on vehicle. The speed indicator goes to long bright light. Matching successful.

If paired incorrectly speed indicator will not light up, turn off car power and repeat steps.

Vehicle must be paired when replacing batteries before using vehicle.

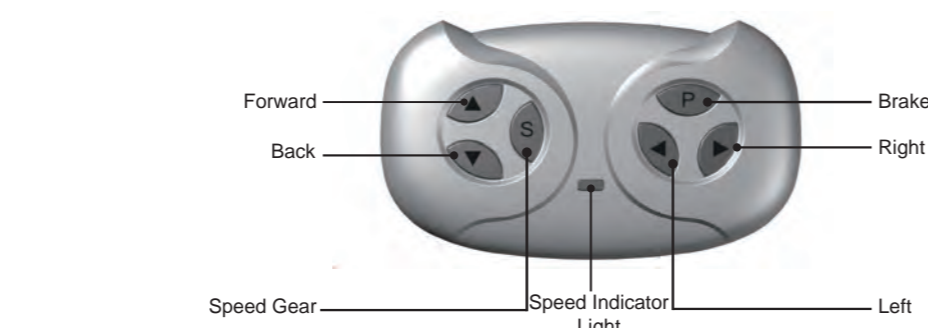

General Use

S Button: Speed Gear Button - Selects 3 different speeds

Low Speed chosen - Speed indicator 1 LED light

Middle Speed chosen - Speed indicator 2 LED light

High Speed chosen - Speed indicator 3 LED light

Tips: Every speed chosen has a slow start.

P Button: will stop the vehicle - Speed indicator flashes.

Forward: Move vehicle in forward motion

Backward: Move vehicle in backward motion

Left: Move vehicle in left direction

Right: Move vehicle in Right direction

9

MANUAL FUNCTION

Precautions:

- The remote control will only work within 15m range of vehicle.
- The remote control suitable for adult only. Keep out of reach of children.
- Read the manual carefully before operating. Adult must be familiar with operating before kid playing the vehicle.
- The remote control has energy-saving settings. When not in use the remote control will turn off automatically after 15 seconds.
- NEVER use in or near roadways, or water, or steep ground. Operate on relatively level ground.
- Keep the remote control away from water or other fluids, otherwise it could damage the remote control.
- Do not re-use previous batteries. Change both batteries at the same time.
- Make sure batteries are installed correctly before turning on.
- Take out the batteries from the remote control during long period of non-use.
- Batteries need replace when the remote control works less than 3m range of vehicle.

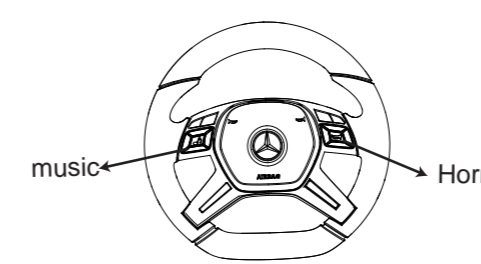
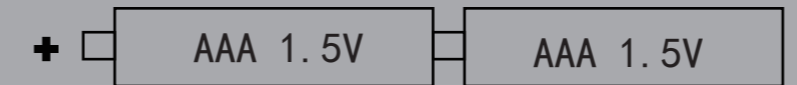

Press the button on the Steering wheel, it will make a sound or play music.

10

MANUAL FUNCTION

The handle operation

1. Turn off the power when battery runs out.
2. Grasp the handle in the middle of the rear, lift the vehicle to 45 degrees and drag.
3. No kids when drag the vehicle.
4. Adult operate only.

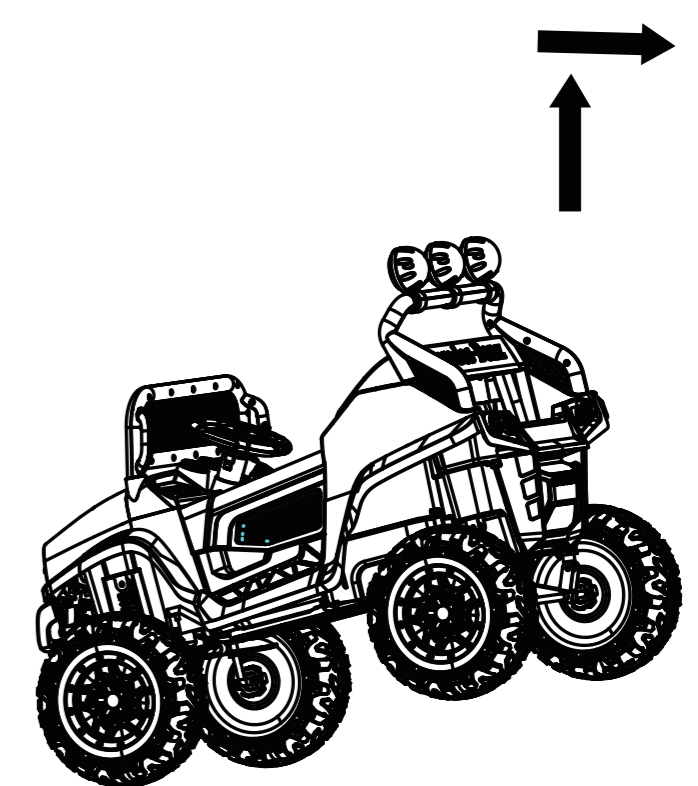

11

MANUAL FUNCTION

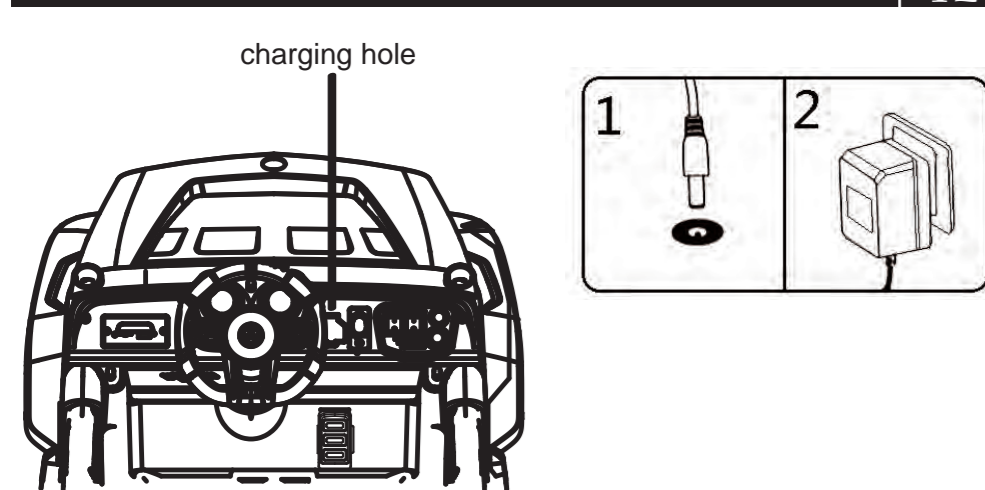

- Power must be turned off when charging.
- Charging slot is located in the middle of dash board.
- Connect the charger plug into charging hole.
- Plug the charger to a household outlet.

Charging Precautions

- Battery charging MUST be carried out by adults.
- When you charge for the first time, the battery has to be charged for 4 hours. Otherwise the battery would be damaged permanently.
- Power must be turned off when charging. NOTED: The car cannot use when charging.
- When the battery runs out, please re-charge. General charging time is 8-12 hours. Do not exceed the recommended charging time.
- It's a normal that the battery casing will be a little fever during charging.
- Keep the charger plug away from water or other fluids. Or it will make a short circuit.
- Before charging, ensure the power supply input complies with the charger input, otherwise don't use it.
- Ensure re-charge the battery at least once a month, even if the vehicle is not in use.
- The charger and battery is not a toy. Keep children away from it.

12

Troubleshooting Guide

Problem	Possible Cause	Solution
Vehicle does not run	1. Run out of battery 2. Tripped thermal fuse 3. Wheel's nut dropped off 4. Battery connectors were disconnected 5. Dead battery 6. Broken motor	1. Re-charge the battery at least 4 hours 2. set the power switch to the "off" position, and wait few minutes before operating again 3. screw up the nut 4. connect the battery connectors again 5. replace a new battery 6. replace a new motor
Battery cannot be re-charged	1. Loose connectors 2. The charger doesn't connected. 3. Broken charger 4. Dead battery	1. plug connectors again 2. Plug the charger to a household outlet again 3. replace a new charger 4. replace a new battery
Short run time (less than 15 minutes)	1. Run out of battery 2. Battery is old and will not accept full charge	1. Re-charge the battery at least 4 hours 2. replace a new battery
Battery makes a sizzling or gurgling noise when charging	It's normal	No action required
Vehicle runs sluggishly	1. Run out of battery 2. Battery is old and will not accept full charge 3. Vehicle is overloaded 4. Driving conditions too stressful	1. Re-charge the battery at least 4 hours 2. replace a new battery 3. Do not exceed the maximum weight capacity 4. use only generally level ground
Gear box makes a gurgling noise	broken gear box	replace a new gear box
The vehicle runs shak	1. Motor wire was loose. 2. Poor quality motor	1. connect the wire again 2. replace a new motor
Steering wheel does not work	remote control's batteries ran out	replace two new batteries
Vehicle cannot stop	Electronic element is damaged	return to maintenance point

13

WARNING

- The assembly and battery charging must be operated by adult.
- Ensure all parts are installed into place before use.
- Always keep child in view when child is in vehicle. Direct adult supervision is required.
- Do not operate in an unsafe, secure environment such as streets, roadways, steep inclines, hills, water, swimming pool or other bodies of water.
- Do not operate on the smooth ground such as marbles, glasses.
- Do not operate in dangerous weather conditions such as rain or snow.
- Do not stand on the vehicle. Only sit on the vehicle.
- Do not change any structure, wire or electronic parts.
- Ensure child has fastened by seat belt when use. Turn off the power after each use. Pull the plug from battery jack during long period of non-use.
- The charger should be examined regularly for damage to the plug, enclosure and other parts. In the event such damage has occurred, the vehicle should be used until it has been repaired.
- This product contains small parts. small parts not for children under 36 months.

14

AFTER SALES SUPPORT

Manufacturer: PingHu City JULONG Children's Commodity Factory
 Address: No. 199, Zhonghua Section, Xinya Line, Xincang Town, Pinghu City, Zhejiang Province
 E-mail: julongcheye@vip.163.com
 Website: www.julongcheye.com
 www.julongcheye.cn